

- Grade II listed, the church was built as a 'chapel of ease' when Shefford was a township in the ancient parish of Campton. It has a 14th/15th Century oblong tower, and is the oldest preserved building in Shefford.
- It is a very simple building which has undergone many restorations and reconfigurations.
- It is a two nave church which is unusual in English church architecture. Beneath the brick arches are original iron columns, known as 'railway architecture'.
- We have a service at 10:00 every Sunday with 08:30 Communion on 1st and 4th Sundays.
- We are privileged to be a town centre church, open every day and hosting many community activities throughout the week.
- Prayed in through the ages, this church, we believe, is a sacred space, and the church and its grounds still provide a space to encounter God through Jesus Christ. We pray that you will experience that today.
- More details are available on the notice board and the church website **sm3a.org.uk** or follow us on Facebook: **St. Michael and All Angels Church.**

Please use this leaflet whilst you explore and keep it to remember your visit today.



 St. Michael and All Angels Church



www.sm3a.org.uk

Acknowledgements and thanks to:

Photography: Karen Brammer
karenbrammerphotography.smugmug.com

Tomkinson Stained Glass
vitraux.co.uk

Beds and Herts Historic Churches Trust, Shefford History Group
and all who have supported the Tower Restoration Project.

Please take a moment to sign our visitors book.



St. Michael and All Angels' Church

Shefford



Free Guide

St. Michael and All Angels' Church, Shefford



Window 1: 1934

Left pane: The Angel Gabriel being sent by God to Mary to tell her she will have a son and she will name him Jesus.
Gospel of Luke Chapter 1 Verses 26-38.

Right pane: The Shepherds visiting Jesus in the manger. The shepherds were visited by angels who told them of the birth of Jesus and so they went to Bethlehem.
Gospel of Luke Chapter 2 Verses 8-17.



Window 2: 1931

Left pane: Jesus in the Temple aged 12 years when he asked a lot of questions and amazed the priests and teachers with his understanding.
Gospel of Luke Chapter 2 Verses 41-52.

Right pane: The baptism of Jesus in the River Jordan by his cousin John the Baptist when the Holy Spirit came down on him in the form of a dove.
Gospel of Mark Chapter 1 Verses 9-11.



Window 3: The East Window 1937

"This is my beloved son; hear ye him"

Jesus took three friends to the top of a mountain. His face became very bright and his clothes white. Two men came and spoke with him, they were Moses and Elijah. A bright cloud covered them and the friends were very frightened. A voice spoke from the clouds and then Jesus was alone with his friends and told them not to be afraid.
Gospel of Matthew Chapter 17 Verses 1-8.

These three windows were designed by Warren Wilson (1924-1952).



Window 4

Left pane: Jesus went to the Mount of Olives to pray and took his friends with him. Jesus stepped away from them to pray and when he returned he found they had fallen asleep.
Gospel of Luke chapter 22 verses 39-46.

Right pane: Jesus is crucified. As Jesus died there was darkness and an earthquake and the soldiers said, "He really was the Son of God..."

All the gospels have accounts of this story and Jesus' resurrection. This window is by Heaton, Butler and Bayne (1862-1953).



The Font

The present font's origins are not known but it was probably installed in the late 1800's. There was a brick font in the chapel by 1708 just inside the main door, the usual place for a font. The font is used for baptism, and to pour the water we use a shell similar to the one in window 2.



The Lectern

In the Christian Church, the lectern is the stand on which the Bible rests and from which the "lessons" (readings from Scripture) are read aloud during the service. Christians believe that the Bible is the Word of God and the carvings on this lectern – a lamp, anchor and sword – remind us of some of the things that the Bible says about the Word of God and how important it is:
"Your word is a lamp to guide me and a light for my path." – Psalm 119:105
"We have this hope as an anchor for the soul, firm and secure...." – Hebrews 6:19
"Accept... the word of God as the sword which the Spirit gives you." – Ephesians 6:17

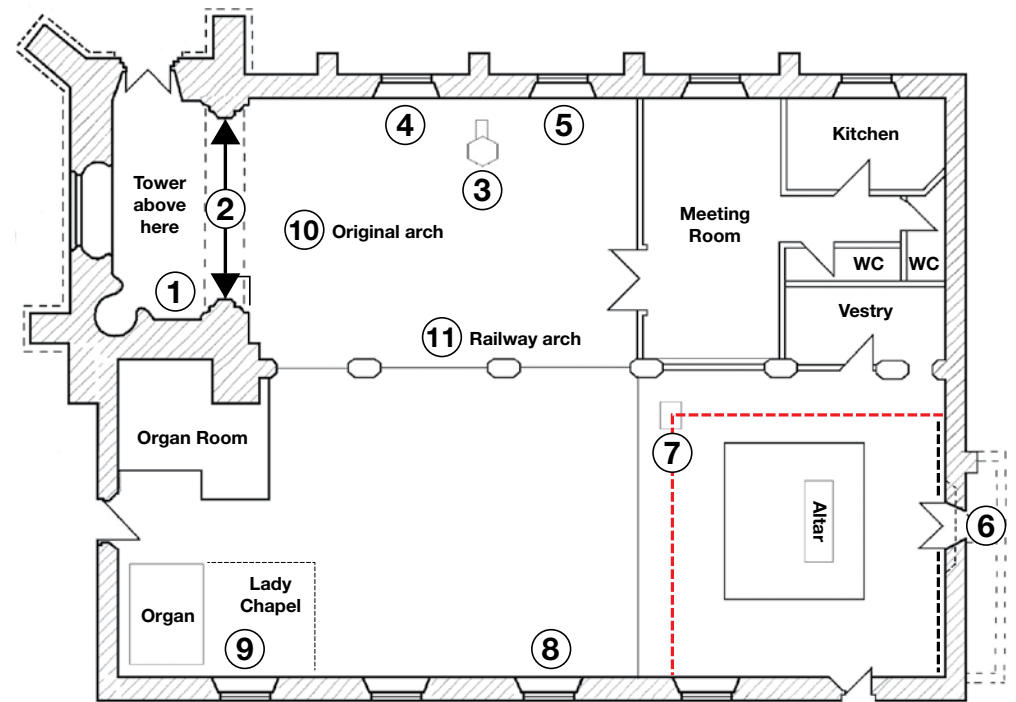

- | | | |
|------------------|-------------|--------------------|
| 1. War Memorial | 5. Window 2 | 9. Woman at Prayer |
| 2. Original Arch | 6. Window 3 | 10. Original Arch |
| 3. Font | 7. Lectern | 11. Railway Arch |
| 4. Window 1 | 8. Window 4 | |

--- Original Screen Position - - - - Current Screen Position

